

# LED BORDERLINE PANEL

60X60 40W 4000 LUMENS, 4000K



  
**4000LM**  
LUMENS

 **40W**  
WATTS

  
**120°**

 **FLICKER  
FREE**



Ideal for hotels, offices, conference / meeting rooms, factories, commercial complexes, residential / institutional buildings, schools, colleges, universities and hospitals.

## Product Features

1. Steady structure, very attractive and aesthetic appearance.
2. High lumens per wattage, saving much for electricity bills.
3. Flicker free driver providing great visual comfort and avoid fatigue of eyes.
4. Super long life up to 30,000 hours with 3 year warranty, maintenance free.

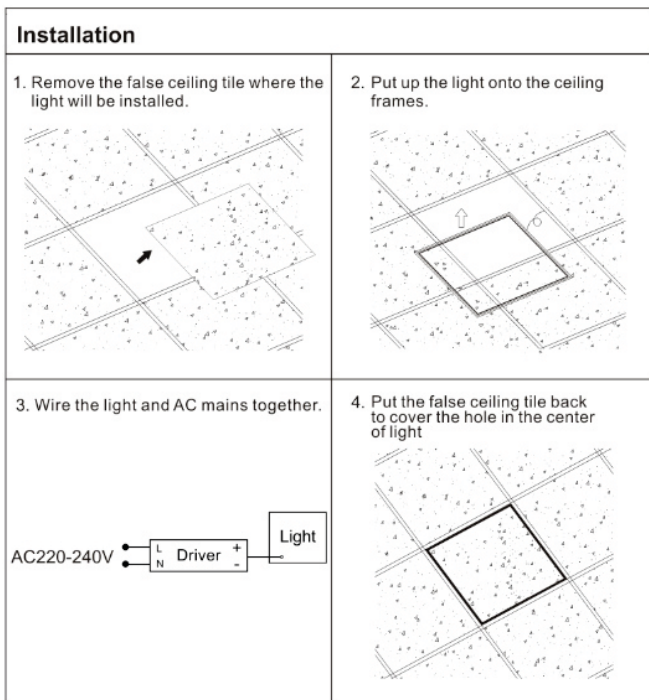

## Technical Specification:

Dimension	:	595*595*10mm
Applications	:	home, office, school, library, mall and laboratory etc
Materials	:	Aluminum housing, PC diffuser
Mode of Lighting	:	back-lit
Emitting		
Rate Wattage	:	40W
SMD Type	:	240pcs of SMD2835, SANAN chip
Luminous Flux & Efficiency	:	4,000 lm, 100 lm/w, A+ energy rating
CRI	:	>80
Beam Angle	:	120°
Ingress Protection	:	Ip20
Rating		
Driver Type options	:	Flicker free – input 220-240v, PF>0.9, THD < 20%, up to 88% efficiency, CE certified
CCT Options	:	Warm white 3,000-3,500K, neutral white 4,000-4,500K, cool white 6,000-6,500K
Lifespan	:	Lifespan 30,000 hours

## Thank you for choosing ENER-J!

Customer satisfaction is our TOP priority, please let us know how you felt about your experience. Happy? We are so happy that you are pleased with our product. Feel free to express your newfound joy! Share your experience by writing a review.

Not Happy? If you are not fully satisfied with the item you received, have any problems like damages, or questions, please contact us. We typically respond within 24-48 hours.

## Stuck? Confused?

Contact our Technical Support team on:

T: +44 (0)2921 252 473 | E: support@ener-j.co.uk

Lines are open Mon - Fri (8am to 4pm)